

Therefore, merely renovating the current space is not an adequate or prudent solution. What is needed is a renovation-expansion project.

In 2009, concurrent feasibility studies confirmed support for this project. In December, approval was granted by the Most Reverend Lawrence Brandt, Bishop of Greensburg, to proceed with the renovation and expansion of Saint Margaret Mary Church, funded by a \$4 million capital campaign with gifts and pledges payable over five years.

The *Rebuilding a House for the Church* campaign builds upon the original vision of Father Joseph Sullivan, it will facilitate the transmission of our faith in Jesus Christ to future generations in our community and it will continue the legacy that began in 1953.

Saint Margaret Mary's *Rebuilding a House for the Church* campaign is a Combined Campaign in conjunction with the *Today's Challenge ~ Tomorrow's Hope* campaign of the Diocese of Greensburg.

Due to the generosity of a Saint Margaret Mary family, our parish's contribution to the *Today's Challenge ~ Tomorrow's Hope* campaign has been completely fulfilled.

Today's Challenge ~ Tomorrow's Hope is a \$45 million capital and endowment campaign that is garnering support across the diocese for:

- Individual Parishes
- Evangelization and Faith Formation
- Catholic Schools
- Ordained Ministry
- Care for Retired Priests
- Lay Ecclesial Ministry
- Catholic Charities
- Diocesan Infrastructure

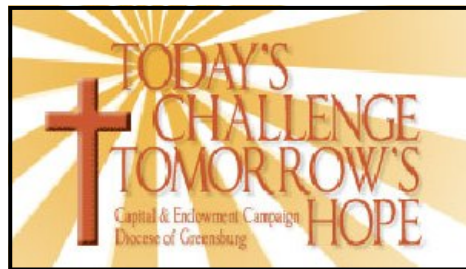

REBUILDING A HOUSE FOR THE CHURCH

THE CAMPAIGN FOR AN EXPANDED WORSHIP SPACE

SAINT MARGARET MARY CHURCH
A PENNSYLVANIA CHARITABLE TRUST
3055 LEECHBURG ROAD
LOWER BURRELL, PA 15068-3451
724-335-2336
WWW.SMMLB.ORG



On September 6, 1953, the first Mass at Saint Margaret Mary Church was celebrated by the founding Pastor, Father Joseph F. Sullivan, in what would become the parish school and what is known today as the Parish Center. The church at that time consisted of 250 families. The church was granted full parish status by the first Bishop of Greensburg, the Most Reverend Hugh Lamb, on June 29, 1955.

The parish rapidly expanded to 600 families by 1957 and in the spring of 1957 ground was broken for a new “temporary” church with the intention of eventually using it for a gymnasium for the school after a more permanent church was built. The “temporary” church stands today, more than 52 years later, as the worship site for Saint Margaret Mary Church. The original church building was converted into a four-room school.

45 years later, in 2002, recommendations were made to update the church for the 21st century. Also in 2002, Saint Margaret Mary School became a part of Mary Queen of Apostles School in New Kensington. The former school building was renovated into the new Parish Center, completed in 2004.

Almost eight years later, problems with the present worship space have increased and remain unresolved. This project requires attention for several reasons:

- All worship space systems are either outdated or inoperable, including: HVAC, electrical and lighting, security, plumbing, roofing and flooring.
- The Diocese of Greensburg projects that there will be significantly fewer clergy available to serve as time goes on. All parishes have been instructed to combine or reduce the number of weekend Masses for this reason.

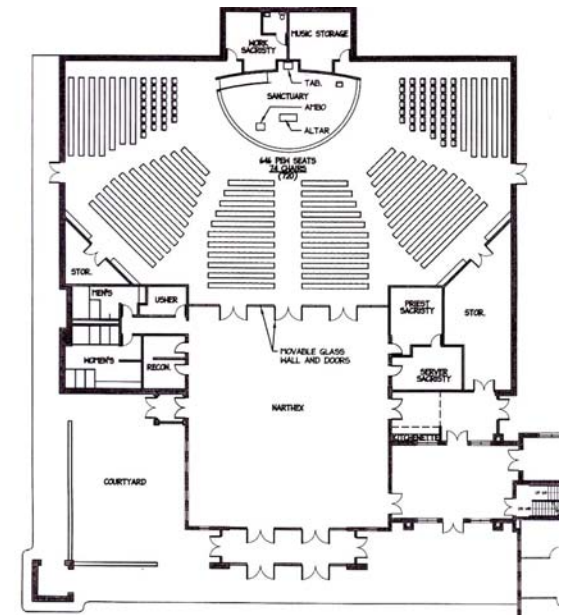

- To accommodate this reality we must expand our present worship space (and parking area) from our current 400+ seats to approximately 700.
- We must provide necessary accommodations for persons with disabilities and the aging when they come to worship.
- The estimated cost of simply renovating the current worship space would be \$2 million. The cost of the complete renovation and expansion is \$4 million.